

MODEL F98X PUMP PARTS LIST (TWO STAGE PUMP)

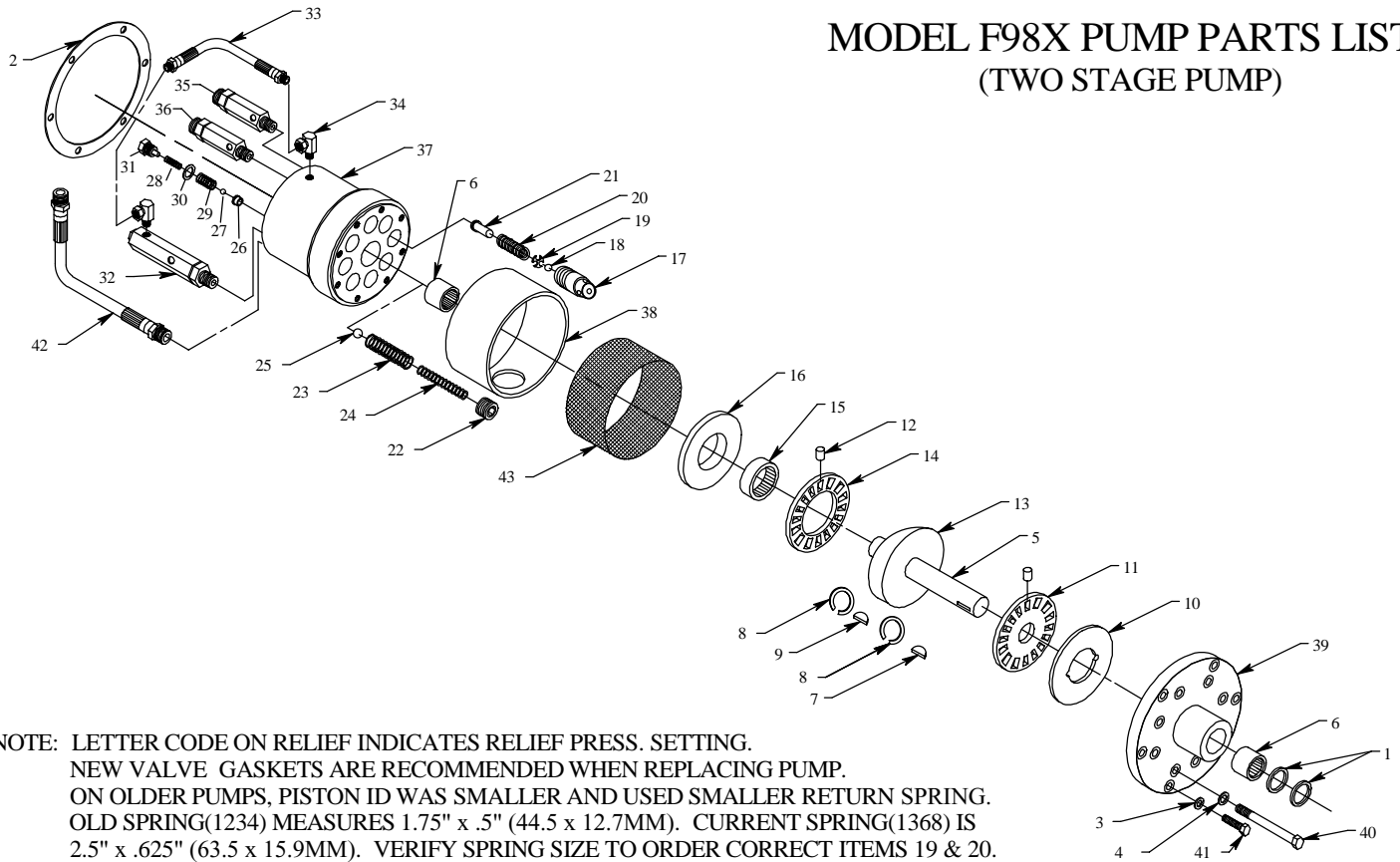

NOTE: LETTER CODE ON RELIEF INDICATES RELIEF PRESS. SETTING.
 NEW VALVE GASKETS ARE RECOMMENDED WHEN REPLACING PUMP.
 ON OLDER PUMPS, PISTON ID WAS SMALLER AND USED SMALLER RETURN SPRING.
 OLD SPRING(1234) MEASURES 1.75" x .5" (44.5 x 12.7MM). CURRENT SPRING(1368) IS
 2.5" x .625" (63.5 x 15.9MM). VERIFY SPRING SIZE TO ORDER CORRECT ITEMS 19 & 20.

NO.	PART NO.	QTY. REQ.	PART DESCRIPTION	NO.	PART NO.	QTY. REQ.	PART DESCRIPTION
	1359		SEAL KIT		1355		CHECK VALVE KIT
1	1028	2	OIL SEAL	22	1221	1	PLUG
2	1012	1	PUMP GASKET	23	2383	1	CAGE SPRING
3	1030	6	ALUMINUM WASHER	24	1216	1	SPRING
4	1108	8	ALUMINUM WASHER	25	1217	1	BALL
	1358		SHAFT AND BEARING KIT		1354		EXHAUST VALVE KIT
5	1075	1	SHAFT	26	1043	8	SEAT
6	1023	2	NEEDLE BEARING	27	1015	8	BALL
7	1027	1	SHAFT KEY	28	2264	8	EXHAUST SPRING
8	1118	2	SNAP RING	29	1041	8	CAGE SPRING
9	1117	1	WOBBLE KEY	30	1009	8	WASHER
	1360		THRUST BEARING KIT	31	1008	8	PORT STUD
10	1080	1	THRUST RACE		1352		UNLOADING VALVE KIT
11	1077	1	FRONT ROLLER RETAINER	32	1245	1	UNLOADING VALVE
12	1119	32	THRUST ROLLER BEARING	33	1351	1	PILOT HOSE
13	1131	1	WOBBLE PLATE	34	1243	2	90° FITTING
14	1078	1	REAR ROLLER RETAINER				REMAINING PUMP PARTS
15	1106	1	THRUST PLATE BEARING	35	2663	1	LOW PRESS. RELIEF } SPECIFY PUMP MODEL,
16	1076	1	PISTON THRUST PLATE	36	1087	1	HIGH PRESS. RELIEF } SERIAL#, PRESSURE & R.P.M.)
	1361		PISTON KIT	37	1242	1	PUMP CASTING (Not Sold Separately)
17	1367	8	PISTON	38	1237	1	INTAKE HOUSING TUBE
18	1168	8	BALL	39	1350	1	FRONT CASTING
19	1366	8	BALL STOP (1233 for old pumps, see note)	40	1107	8	PUMP ASSEMBLY BOLT
20	1368	8	SPRING (1234 for old pumps, see note)	41	1035	6	MOUNTING CAP SCREW
21	1369	8	SPRING PIVOT	42	--		HOSE - SPECIFY RESERVOIR SIZE WHEN ORDERING
				43	1515	1	INTAKE SCREEN